

Air solenoid valve

JMEBH-5/2-1/8-S-B-230AC

Part number: 173083

FESTO

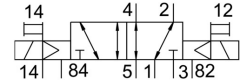
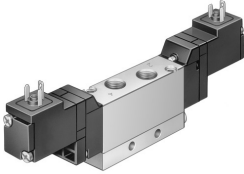

Data sheet

Feature	Value
Valve function	5/2, bistable
Actuation type	Electrical
Width	17.8 mm
Standard nominal flow rate	650 l/min
Pneumatic working port	G1/8
Operating voltage	230V AC
Operating pressure	-0.9 bar ... 10 bar
Structural design	Piston gate valve
Reset method	Pneumatic spring
Certification	c UL us - Recognized (OL)
CE marking (see declaration of conformity)	As per EU low voltage directive
Degree of protection	IP65
Nominal width	5 mm
Width dimension	18 mm
Type code	JMEBH
Exhaust air function	With flow control option
Sealing principle	Soft
Mounting position	Any
Manual override	Detenting via accessory
Type of control	Pilot-controlled
Pilot air supply port	External
Flow direction	Reversible
Symbol	00991196
Lap	Overlap
Pilot pressure	1.5 bar ... 8 bar
b-value	0.42
C value	3.25 l/sbar
Changeover time	10 ms
Duty cycle	100%
Coil characteristics	230 V AC: 50/60 Hz, initial power 3.0 VA, holding power 2.4 VA
Operating medium	Compressed air as per ISO 8573-1:2010 [7:4:4]
Information on operating and pilot media	Operation with oil lubrication possible (required for further use)
Vibration resistance	Transport application test with severity level 1 as per FN 942017-4 and EN 60068-2-6
Shock resistance	Shock test with severity level 2 as per FN 942017-5 and EN 60068-2-27
Corrosion resistance class (CRC)	2 - Moderate corrosion stress

Feature	Value
Storage temperature	-20 °C ... 40 °C
Temperature of medium	-5 °C ... 50 °C
Noise level	75 dB(A)
Pilot medium	Compressed air as per ISO 8573-1:2010 [7:4:4]
Ambient temperature	-5 °C ... 50 °C
Product weight	142 g
Electrical connection	Form C Plug as per EN 175301-803 Rectangular design
Type of mounting	With through-hole
Pilot exhaust air port 82/84	M5
Pilot air port 12	M3
Pneumatic connection 1	G1/8
Pneumatic connection 2	G1/8
Pneumatic connection 3	G1/8
Pneumatic connection 4	G1/8
Pneumatic connection 5	G1/8
Note on materials	RoHS-compliant
Seals material	HNBR NBR
Housing material	Die-cast aluminum